

RECOMMENDED P.C.B. LAYOUT  
TOLERANCE:±0.05 TOP VIEW

- PCB AREA
- CONNECT AREA
- KEEP OUT AREA

**MATERIALS**

1. HOUSING : THERMOPLASTIC (UL 94V-0) .
2. TERMINAL : COPPER ALLOY,  
PLATING : GOLD PLATED ON CONTACT AREA  
AND SOLDER TAILS,NICKEL PLATED OVERALL.
3. SHELL : STAINLESS STEEL.  
PLATING : NICKEL PLATED OVERALL.  
GOLD PLATED ON SOLDER TAILS

**SPECIFICATION**

1. CURRENT RATING : 1.0 A MAX.
2. DIELECTRIC WITHSTANDING VOLTAGE :  
500V AC R.M.S. FOR ONE MINUTE.
3. INSULATION RESISTANCE : 1000MMIN. AT 500V DC.
4. CONTACT RESISTANCE : 30m MAX.
5. OPERATING TEMPERATURE : -40°C TO +85°C.

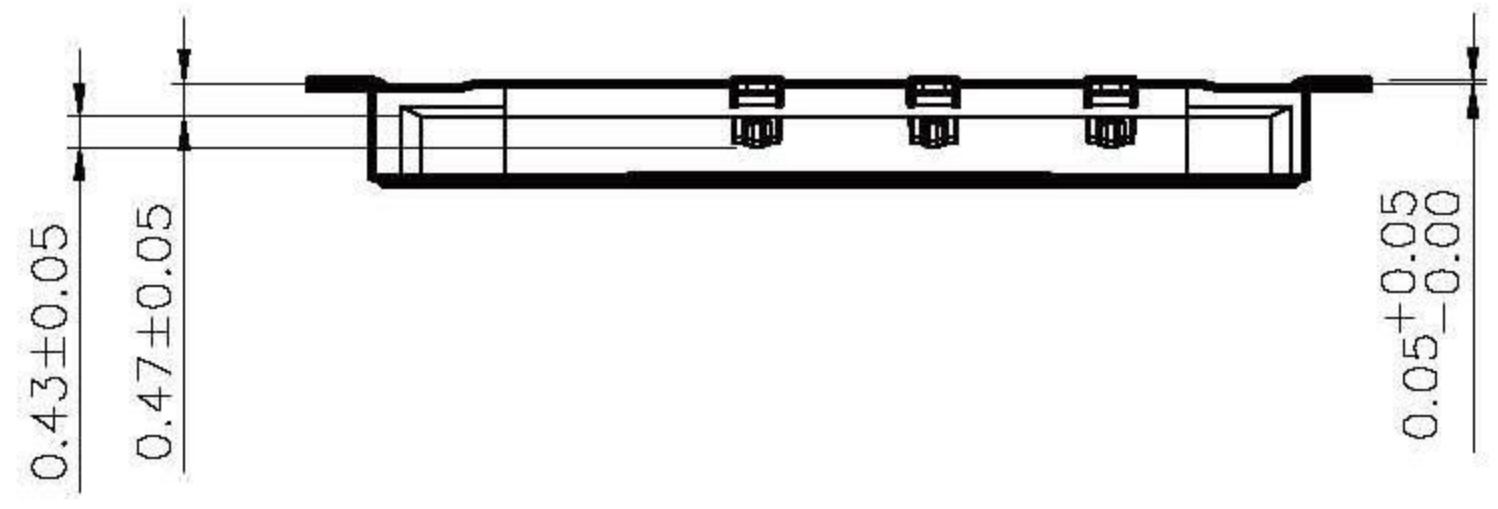

***HOW TO ORDER***  
**ASM-M1413-06D**

Special Options

 Sugo Products www.sugo.com.hk	DIMENSION	mm	DATE	REVISION	APPROVAL BY
	DRAW BY	Joe			
	APPROVAL BY	Rikki			
	DATE				

DESCRIPTION: Micro SIM Socket Connector / 6Pin /S.M.D