

△ PCB Layout

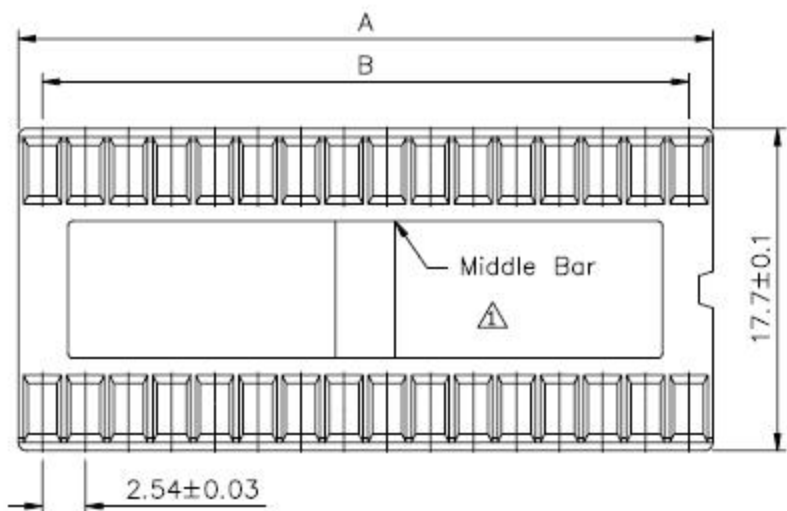

PCB Layout

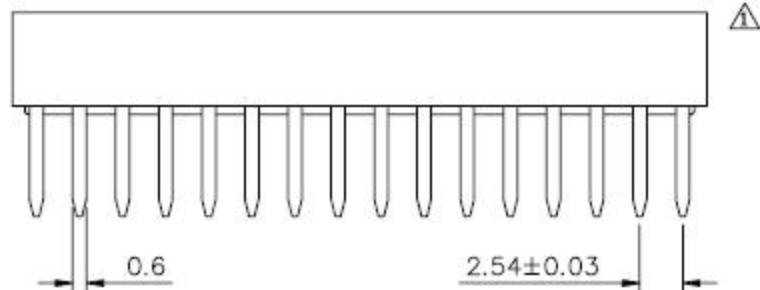
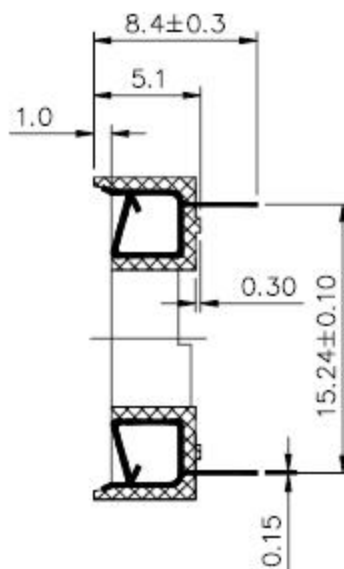

△ SPECIFICATION

Current Rating: 1 mA
 Dielectric Withstanding Voltage: 1000V AC/5s
 Insulation Resistance: 1000 Megaohms 500V DC
 Operation Temperature: -55°C~+105°C
 Insulator: PBT+G.F. UL94V-0, Black
 Contact: Phosphor Bronze, Tin Plated
 Contact Separation Force: 0.5kg/Pin Min.
 RoHS Compliant

Contacts	A±0.08	B±0.10	Remark
24	30.48	27.94	With Middle Bar
28	35.56	33.02	
32	40.64	38.10	
40	50.80	48.26	
42	53.34	50.80	
48	60.96	58.42	

DATE	REVISION	APPROVAL BY	DIMENSION	mm	DRAW No	PART No
			DRAW BY	Alexander		IC01-XXP-DP15
			APPROVAL BY	Ribbi		DIP PROFILE IC SOCKET
			DATE		SUGO INDUSTRIAL CO., LTD. TEL : 852-27901280 FAX : 852-23890688 Email : sales@sugo.com.hk	